

2040N  
2020N  
2000N  
1980N  
1960N  
1940N

1020E  
1040E  
1060E  
1080E  
1100E  
1120E  
1140E

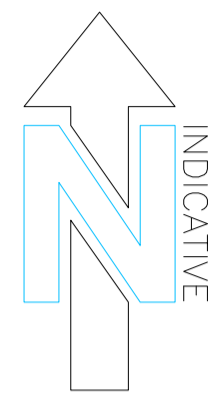

STATION	EASTING	NORTHING	HEIGHT	DESCRIPTION
1	1131.199	2021.209	42.511	NAIL
2	1115.633	1983.441	41.169	NAIL
3	1109.408	2007.372	41.193	NAIL
4	1110.102	2019.719	41.521	PEG
5	1061.285	2007.013	41.116	NAIL
6	1094.297	1951.775	39.928	NAIL
7	1080.494	1972.146	40.170	NAIL
8	1067.663	1963.057	39.931	PEG
9	1036.372	1961.418	40.652	NAIL
10	1052.263	1990.986	40.480	NAIL
11	1005.000	2005.000	42.383	PEG
12	1049.804	2082.605	44.020	NAIL

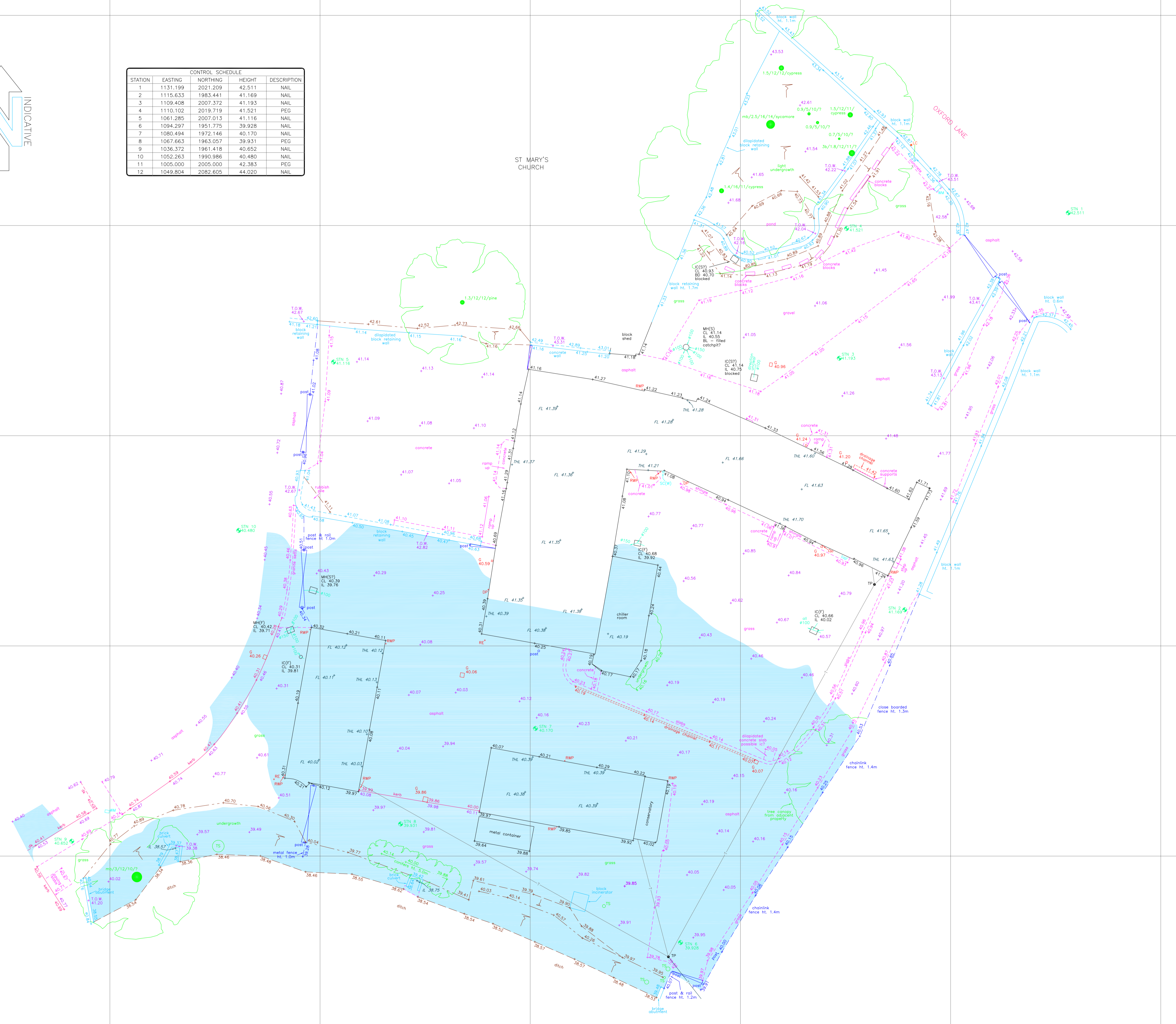

# LEGEND

- AV AIR VENT
- B BILLIARD
- BB BELISHA BEACON
- BH BORE HOLE
- BL BASE/BD LEVEL
- BP BRICK PILLAR
- BS BUS STOP
- CA/SB COMBINED (SEWER)
- CAJB CABLE JUNCTION BOX
- CAIV CABLE INSPECTION COVER
- CIP CABLE INSPECTION POINT
- CD CABLE DUCT
- CL COVER LEVEL
- CP CATCH PIT
- DP DOWN PIPE
- DPC DAMP PROOF COURSE
- DK DROP KERB
- EIC ELECTRICITY INSPECTION COVER
- EJB ELECTRICITY JUNCTION BOX
- EP ELECTRICITY POLE
- ER EARTHING ROD
- F FOUL (SEWER)
- FB FLOWER BED
- FH FIRE HYDRANT
- FL FLOOR LEVEL
- G GULLY
- GIC GAS INSPECTION COVER
- GJB GAS JUNCTION BOX
- GV GAS VENT
- IC INSPECTION COVER
- IL INVERT LEVEL
- JB JUNCTION BOX
- LB LITTER BIN
- LC LIGHTING COLUMN
- MH MANHOLE
- MK SERVICE MARKER (E) ELECTRIC (G) GAS (W) WATER
- OH/W OVERHEAD WIRE
- OSBM ORDNANCE SURVEY BENCH MARK
- P POST
- PB POST BOX
- RE RODDING EYE
- RNP ROAD NAME PLATE
- RS ROAD SIGN
- RW RETAINING WALL
- RWP RAIN WATER PIPE
- S STORM (SEWER)
- SC STOP COCK (G) GAS (W) WATER
- SP SIGN POST
- SEG SIDE ENTRY GULLY
- STN SURVEY STATION
- STP SUPPORT FOR TELEPHONE POLE
- SV STOP VALVE
- SVP SOIL VENT PIPE
- TBM TEMPORARY BENCH MARK
- TCB TELEPHONE CALL BOX
- TH THRESHOLD
- THL THRESHOLD LEVEL
- TIC TELEPHONE INSPECTION COVER
- TJB TELEPHONE JUNCTION BOX
- T.O.W. TOP OF WALL
- T.P. TELEPHONE POLE
- TS TREE STUMP
- UTL UNABLE TO LIFT
- VP VENT PIPE
- WL WATER LEVEL
- WM WATER METER
- WO WASH OUT

TREE (girth/spread/height/species)
 DIRECTION OF LEAN

TREE GIRTHS AND SPREADS ARE QUOTED AS A MEAN SIZE, AND SHOWN TO SCALE.

WHILST EVERY EFFORT IS MADE TO IDENTIFY TREE SPECIES AND GAUGE HEIGHTS, NO RESPONSIBILITY CAN BE TAKEN FOR THE ACCURACY OF THIS INFORMATION.

WHILST EVERY EFFORT IS MADE TO ENSURE THAT PIPE DIAMETERS, INVERT LEVELS AND DRAINAGE TYPES ARE CORRECT, THE ACCURACY OF THIS INFORMATION CANNOT BE GUARANTEED, AND IT IS STRONGLY RECOMMENDED THAT EXISTING INFORMATION IS CHECKED PRIOR TO THE COMMENCEMENT OF ANY DETAILED DESIGN AND CONSTRUCTION WORKS.

NO RESPONSIBILITY CAN BE TAKEN FOR DRAINAGE INFORMATION OBTAINED FROM SOUTHERN WATER RECORDS.

LEVELS AT KERB LINES ARE CHANNEL LEVELS.

ALL LEVELS DERIVED BY GPS USING ORDNANCE SURVEY ACTIVE RINEX DATA.

HATCHING AREA INDICATES AREA THAT IS BELOW FLOOD LEVEL VALUE OF 40.50M.

REV.	DESCRIPTION	DATE	INITIAL



**Geomatics Limited**  
 Shine Barn, Shrine Farm, Sandling Road, Postling, Hythe, Kent, CT21 4HE  
 Tel : 01303 261212 Fax : 01303 264040  
 Email : survey@jcwhite.co.uk Web site : www.jcwhite.co.uk

- GPS surveys
- volumetric surveys
- topographical surveys
- measured building surveys
- setting out
- boundary disputes
- engineering surveys
- deformation & settlement surveys

CLIENT  
**J.C. WHITE GEOMATICS LIMITED**

JOB TITLE  
**SAMPLE SURVEY**

DRAWING TITLE  
**FLOOD PLAIN MAPPING**

JOB No. 00/00/001 DATE NOVEMBER 2007

SURVEYED BY R.Williams DRAWN BY R.Williams

SCALE N.T.S. DWG. No. 1 REV. No.

CAD PLOT DATE ORIGINAL SHEET SIZE CADFILE NAME  
 14.11.07 A1 SAMPLE\_FLOOD\_SURVEY.dwg